

**WDA05 (2000 mm) - WDA06 (3000 mm)**

Accessories / Accessori



L&L Luce&Light reserves the right to change the information contained in this document at any time without prior notice being given.  
*Le informazioni contenute nel presente documento possono essere modificate in qualsiasi momento senza preavviso e non comportano l'assunzione, nemmeno implicita, di alcuna obbligazione da parte della L&L Luce&Light srl.*

**INSTALLATION DIAGRAMS / DIAGRAMMI DI INSTALLAZIONE**

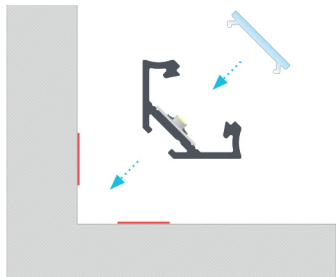
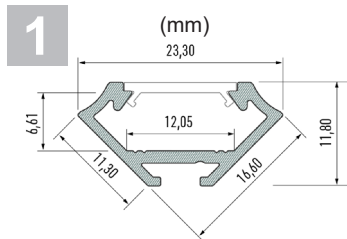

Installation manual for WDA05-06 profile with [WDA05: WR0000S1T or WR0000S1S or WR0000S1M (2000 mm), WDA06: WR0000S2T or WR0000S2S or WR0000S2M (3000 mm)] cover using double-sided tape.

*Istruzioni di montaggio del profilo WDA05-06 con diffusore [WDA05: WR0000S1T o WR0000S1S o WR0000S1M (2000 mm), WDA06: WR0000S2T o WR0000S2S o WR0000S2M (3000 mm)] con nastro biadesivo.*

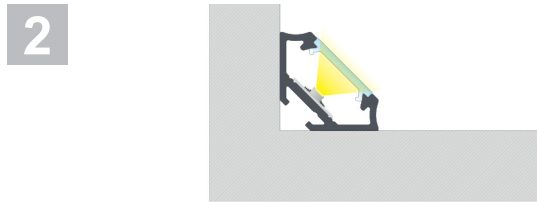

The end result of assembly of corner profile WDA05-06 with cover using double-sided tape.

*Effetto finale del montaggio del profilo WDA05-06 angolare con diffusore con nastro biadesivo.*

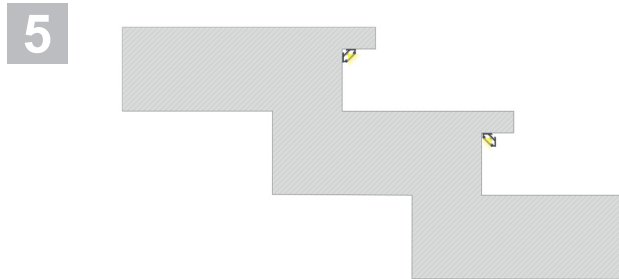

Examples of mounting the profile WDA05-06 on the surface of a step.

*Metodi di montaggio del profilo WDA05-06 sulla superficie dei gradini.*



Connecting profiles WDA05-06 with cover at 90°.

*Collegamento dei profili WDA05-06 con diffusore con angolo di 90 gradi.*

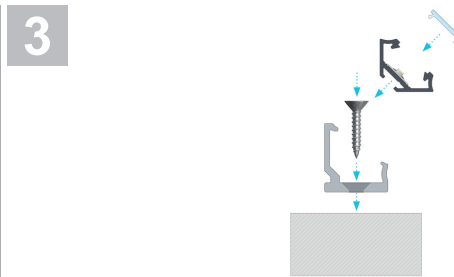

Installation manual for corner WDA05-06 profile with cover, using plastic mounting clip WT0000020.

*Istruzioni di montaggio del profilo WDA05-06 angolare con diffusore mediante basetta di fissaggio WT0000020 in plastica.*

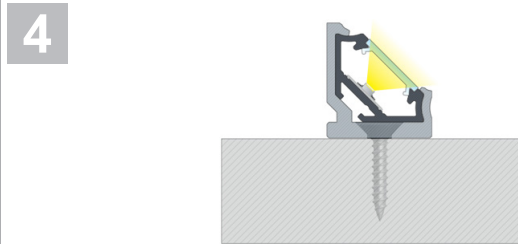

The end result of assembly of corner profile WDA05-06 with cover using plastic mounting clip WT0000020.

*Effetto finale del montaggio del profilo WDA05-06 angolare con diffusore mediante bassetta di fissaggio WT0000020T in plastica.*

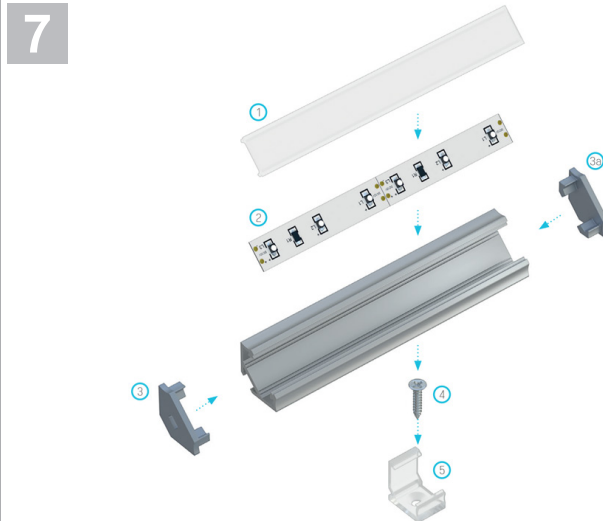

Assembly scheme for elements of the lighting system using profile WDA05-06 and (1) [WDA05: WR0000S1T or WR0000S1S or WR0000S1M (2000 mm), WDA06: WR0000S2T or WR0000S2S or WR0000S2M (3000 mm)] cover, (2) a LED strip, (3) an end cap with hole WEA06, (3a) an end cap without hole WEA05, (4) a screw, (5) a mounting clip WT0000020.

*Schema di montaggio degli elementi del sistema di illuminazione con l'uso del profilo WDA05-06 angolare e (1) del diffusore [WDA05: WR0000S1T o WR0000S1S o WR0000S1M (2000 mm), WDA06: WR0000S2T o WR0000S2S o WR0000S2M (3000 mm)], (2) della striscia LED, (3) del tappo con foro WEA06 (3a) del tappo senza foro WEA05, (4) della vite di montaggio, (5) della basetta di fissaggio WT0000020.*